

# OFFSET STRAIGHT PULL HANDLES FITTING INSTRUCTION

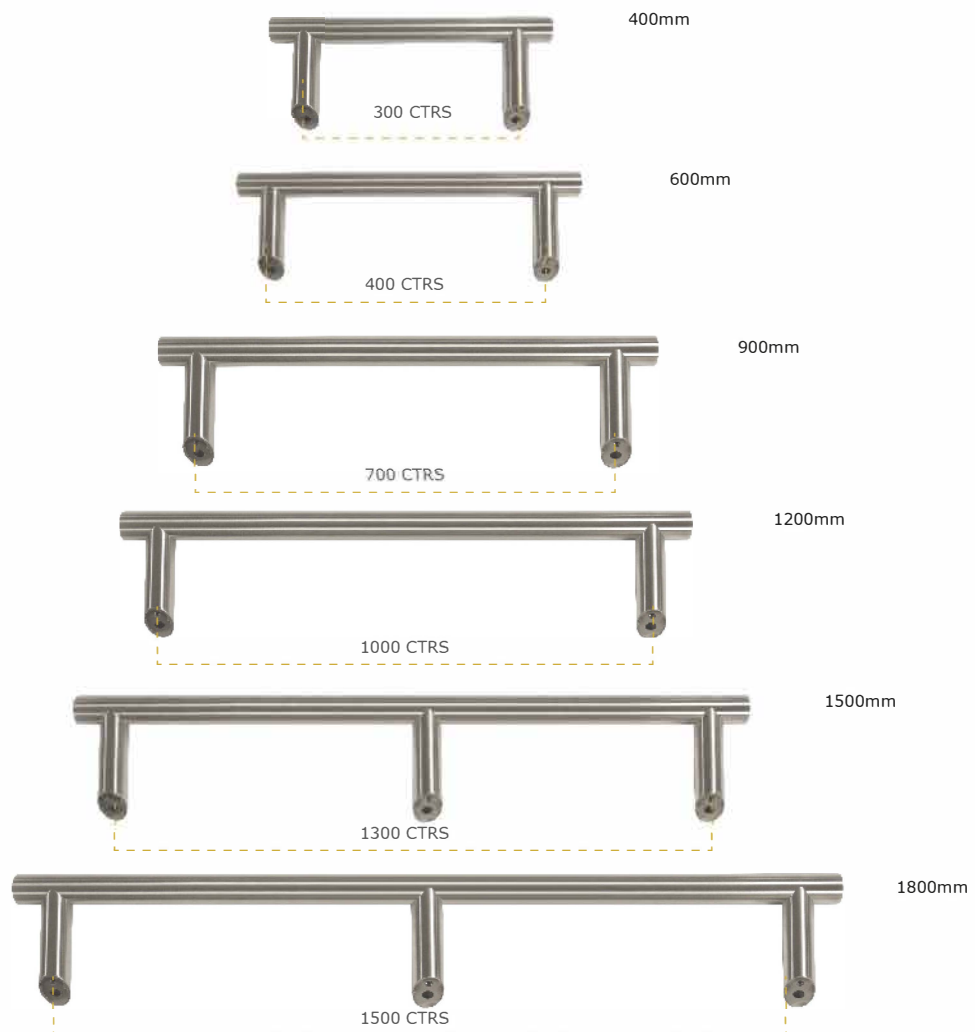

## BACK TO BACK FIX

### FITTING

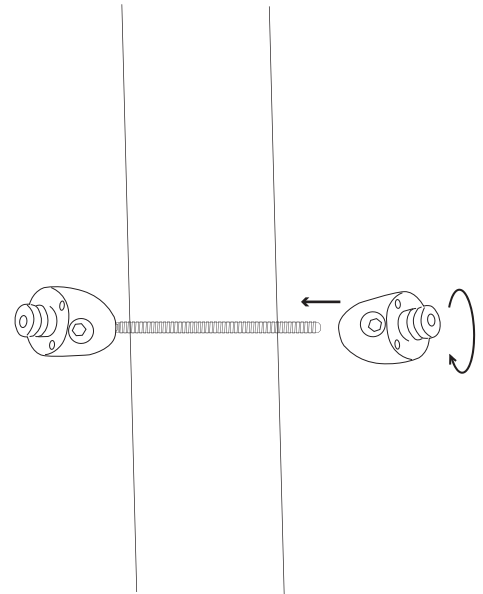
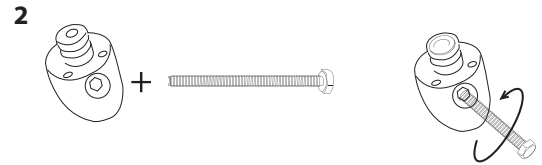
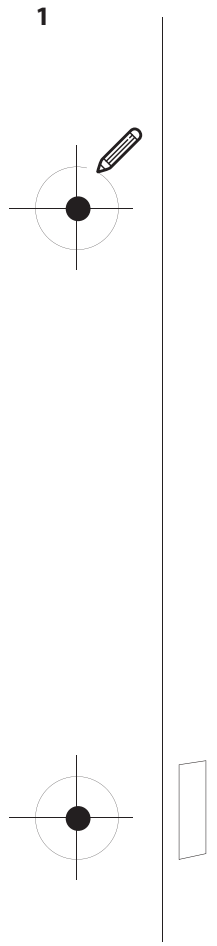
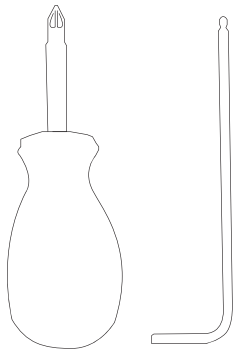
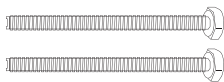
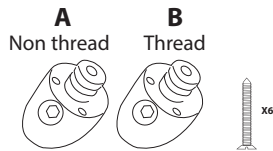

3

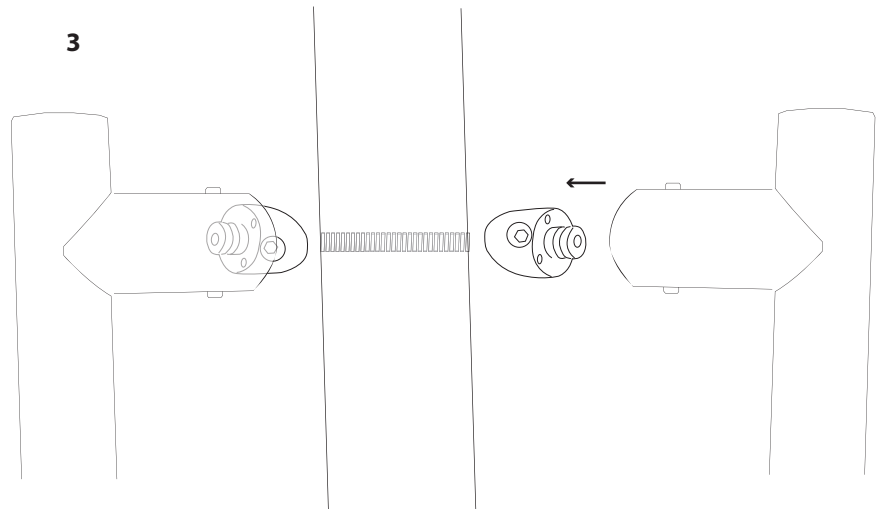

4

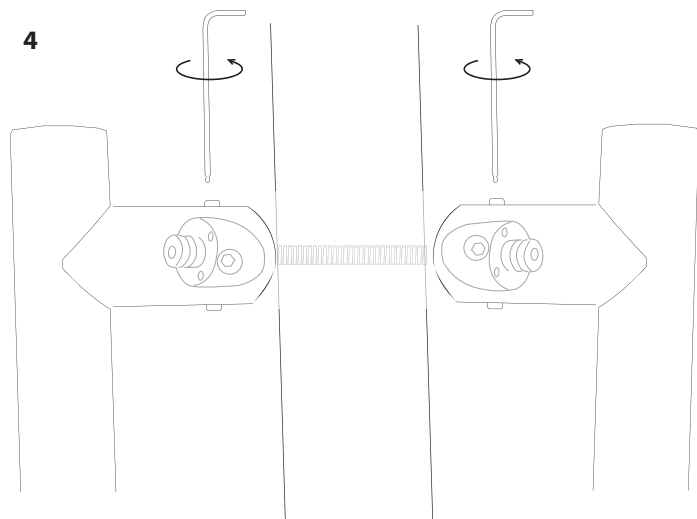

### Method 1: BACK TO BACK

1) Suitably line the holes up to where the handle will be fitted on the door making sure it is straight (refer to page 1, tech sheet, for centres) and drill the holes in the door where you have marked.

2) Take 'fitting A' and feed through the bolt. Screw 'fitting B' onto the other side.

3) Push each handle onto its fixings.

4) Screw the grub screws up tightly to secure the fitting.

\*5) For security you can round off the grub screws.

## BOLT THROUGH FIXING (ONE SIDE ONLY)

### FITTING A



### CAPS



### BOLTS

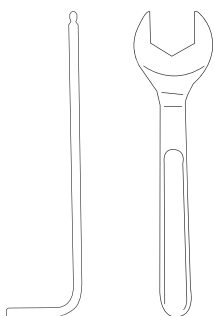
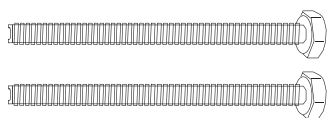

### Method 2: BOLT THROUGH FIXING – ONE SIDE ONLY

1) Suitably line the holes up to where the handle will be fitted on the door making sure it is straight (Refer to page 1, tech sheet, for centres) and drill the holes in the door where you have marked.

2) Feed the bolt through the hole and screw in 'fitting A'.

3) Push the handle onto 'fitting A' and screw the grub screws up tightly to secure the fitting.

4) Put the cap on the bolt at the back of the door.

1



2

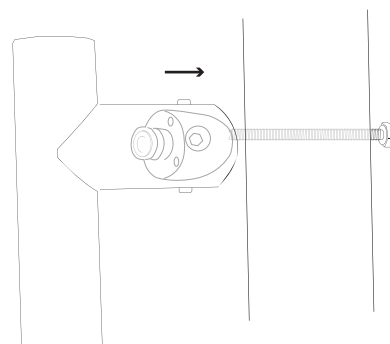
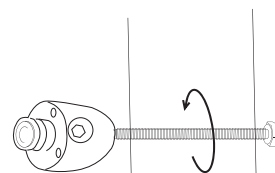
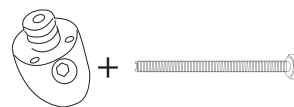

3

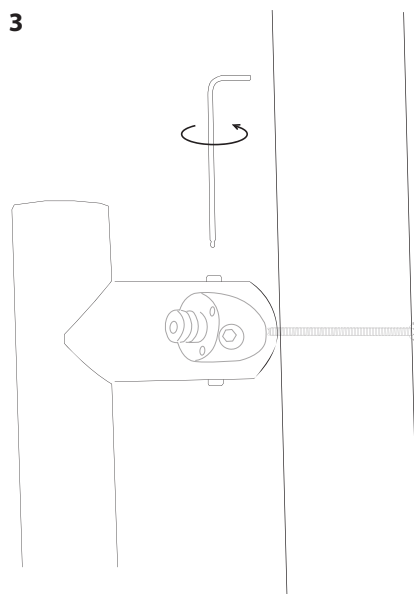

4

