



Please ensure boxes are ticked after each step has been completed.

**External Doorset Installation Guide
For Use with Cavalok Structural Door Sets**

Step 1: ☐

Ensure aperture size to doorset is correct. It is recommended 5mm to 10mm maximum tolerance per side to enable correct installation. Opening should be square and plumb.

Step 2: ☐

Remove braces correctly by unscrewing them from the structural closer.

Step 3: ☐

Check the structural closer is fitted tight in the cavity. The structural closer should not be able to move and fitted flush to the brick and block work. If this is not the case, then do not carry on and inform site manager. Please refer to Cavalok Structural Closer Guide for information.

Step 4: ☐

Ensure that the brickwork the doorset will sit on is level, cleaned down and clear of all debris/mortar.

Step 5: ☐

Attach straps to door frame. 5 per side on a 2100mm frame, 6 per side on a 2325mm frame with fanlight. First straps to be fitted 150mm from top and bottom of frame, Intermediate fixings should be at centres no greater that 450mm (as per GGF guidelines). (If extra straps are needed on the head this is down to the fitter's discretion). Ensure the strap is fixed back to the profile using a suitable screw.

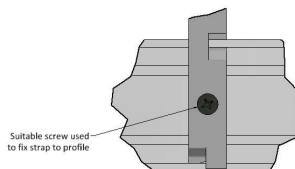
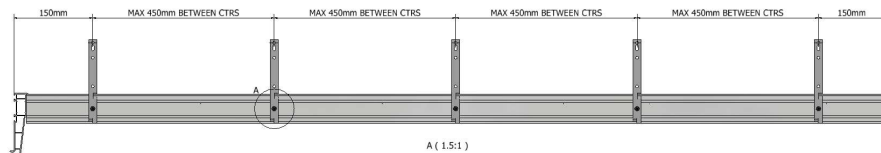

Step 6: ☐

Apply 2 lines of silicone sealant to the face on which the cill will sit on to prevent water ingress.

Step 7: ☐

Ensure the door is positioned in the centre of the aperture. Position the door set back 38mm from the internal face of the outer brickwork as per CAVALOK location sticker. (See drawing STR100).

Step 8: ☐

Ensure the door frame is square and plumb using a spirit level. Use packers between the jambs and cavity closer to keep the frame secure.

Step 9: ☐

Using the correct Hertings kit supplied and suitable packers fix the hinge side in place using the top and bottom straps first. The 102mm screw is to be used to fix through the frame into the structural closer, the 52mm screw is to be used to fix through the strap into the structural closer and the SFS 65mm aircrete fixing is to be used to fix through the strap into the light density block work as shown in the picture below (See drawing STR100).

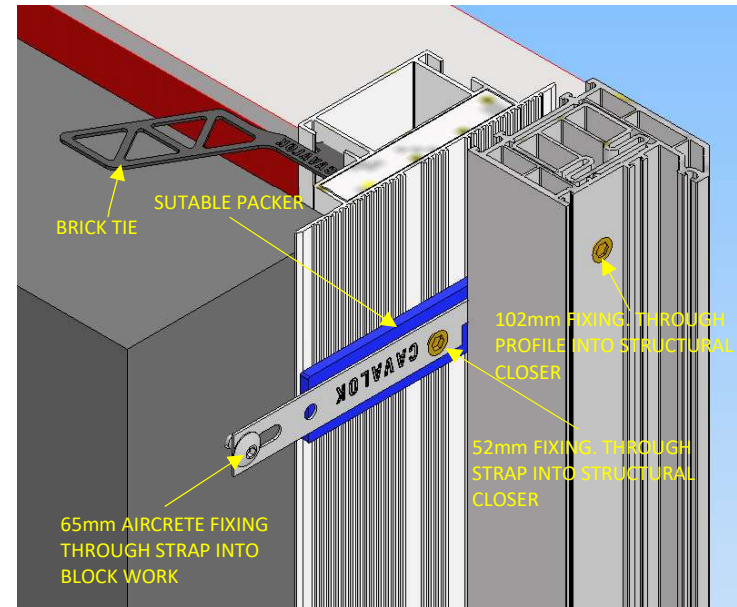

Step 10:

Repeat step 9 for the lock side of the frame.

Step 11:

Check to see if the frame has remained square and plumb, if so, fit all remaining fixings to the remaining straps. If the frame is no longer square and plumb, remove fixings, re set the frame and repeat steps 9 and 10.

Step 12:

Ensure gaps between door and frame on the inside are a consistent 4-5mm at the head and down each jamb. Adjust frame fixings to correct if necessary.

Step 13:

Check operation of door and lock. Adjust as required in accordance with Vista Panels instructions.

Step 14:

Fill between the frame and the structural closer using expanding foam. Once the foam has dried apply silicon sealant to the outer frame.

The aluminium threshold should now be removed and stored until completion. When refitting, a bead of silicone between the threshold and cill is required before screwing to the cill. Ensure the threshold is carefully replaced as forcing it can rip the gasket from the frame. Ensure drainage channels are free from debris and sealant.

Please Note:

If a doorset is fitted during the construction phase, then keep it closed to avoid bowing, ensure top and bottom locking points are engaged to assist in the reduction of thermal movement. If held open for long periods, especially if the doorset has not yet been foam filled or mastic sealed, the doorleaf should be wedged when held open.

The code of practice for installation as issued by the British Plastics Federation should always be complied with. Failure to install your doorset and all associated items in strict accordance with these instructions may invalidate any future warranty claim.

Please make sure all steps have been followed and all boxes have been ticked to show this.

Name - _____

Date - _____

Site - _____

Plot Number - _____

Sign - _____

CAVALOK 100mm - DOOR SET ASSEMBLY DETAIL

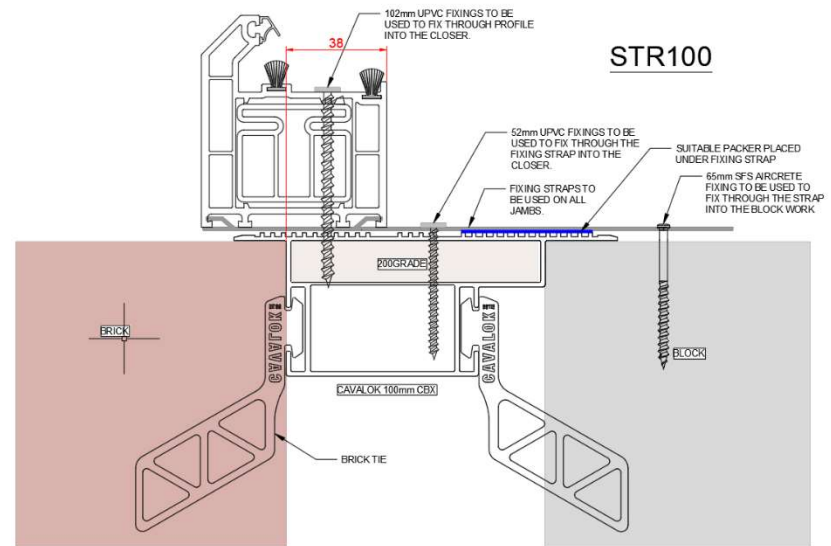

For installation video please scan the QR code -
Or please visit - www.youtu.be/jEGnw6d8aik